



Wynchgate

Harrow

£600,000

A three bedroom, semi-detached house available in an excellent, cul-de-sac, location with Davidson Frost-Wellings.

Downstairs the house has a welcoming hallway, double reception room with bay window and sliding doors leading to the rear garden, plus a separate new kitchen. Upstairs the house has two double bedrooms, and additional third bedroom, a very large family bathroom and separate WC.

The property is available with an elevated position on the road, an attractive front garden and a West-facing rear garden. In addition there is a shared driveway and a large, separate, extended garage.

Wynchgate is a quiet residential road within close proximity to Stanmore Broadway and Harrow Weald High Road with a variety of shops, restaurants and transport links to Central London in less than thirty minutes. The house is located within a few minutes walk of Weald Rise Primary School.

Harrow Council Tax Band E.

- Three Bedrooms
- Good Condition Throughout
- Large Detached Garage
- Cul-De-Sac Location
- Double Reception Room
- Semi Detached Freehold

Viewing

Please contact our Davidson Frost-Wellings Office on 020 8954 8806 if you wish to arrange a viewing appointment for this property or require further information.



Floor Plan

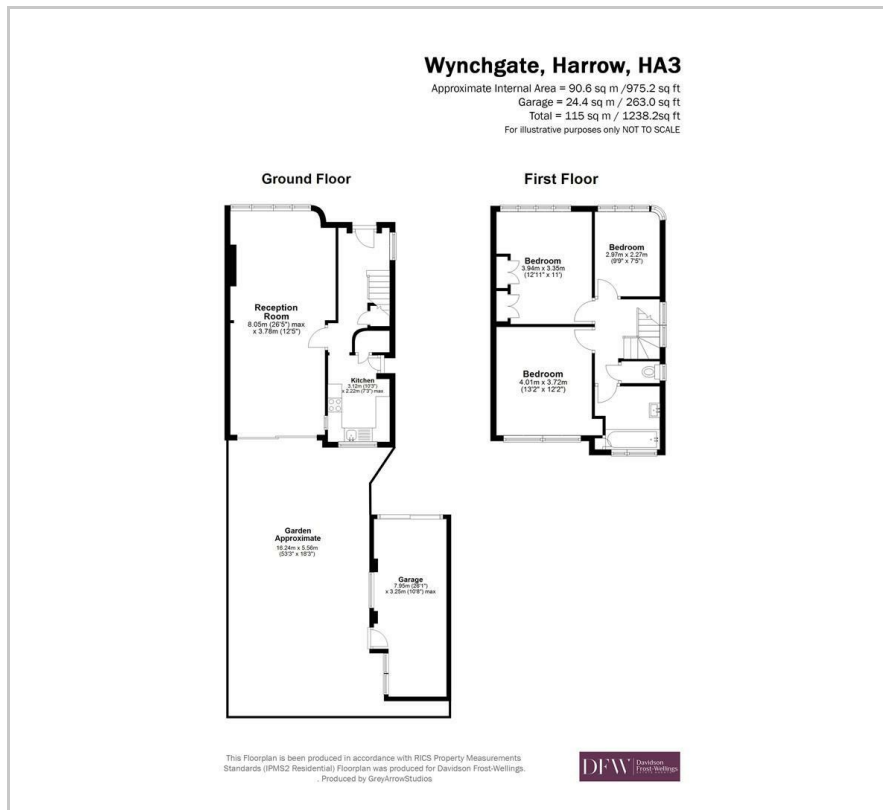

Area Map

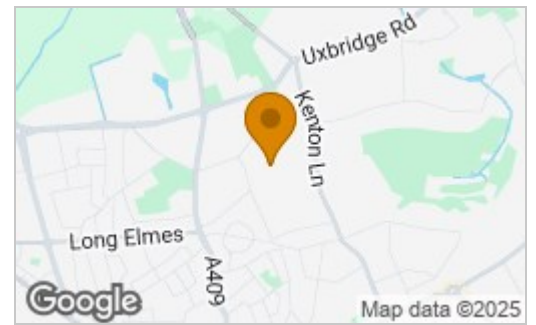

Energy Efficiency Rating

	Current	Potential
Very energy efficient - lower running costs		
(92 plus) A		
(81-91) B		82
(69-80) C		
(55-68) D	60	
(39-54) E		
(21-38) F		
(1-20) G		
Not energy efficient - higher running costs		
England & Wales	EU Directive 2002/91/EC	



These particulars, whilst believed to be accurate are set out as a general outline only for guidance and do not constitute any part of an offer or contract. Intending purchasers should not rely on them as statements of representation of fact, but must satisfy themselves by inspection or otherwise as to their accuracy. No person in this firm's employment has the authority to make or give any representation or warranty in respect of the property.